

HISTORIC BUILDINGS *MATTER*

America's historic buildings are invaluable treasures; built through challenging work and perseverance, these structures reflect our shared history, values, and hardships. They are storied and lasting, an opportunity for each generation to discover what came before.

WE CHERISH & RESTORE THEM

The Durable Slate and Restoration Companies are award-winning historic roofing and preservation companies. We are experts in historic roofing, masonry, plaster, custom metalwork, and more.

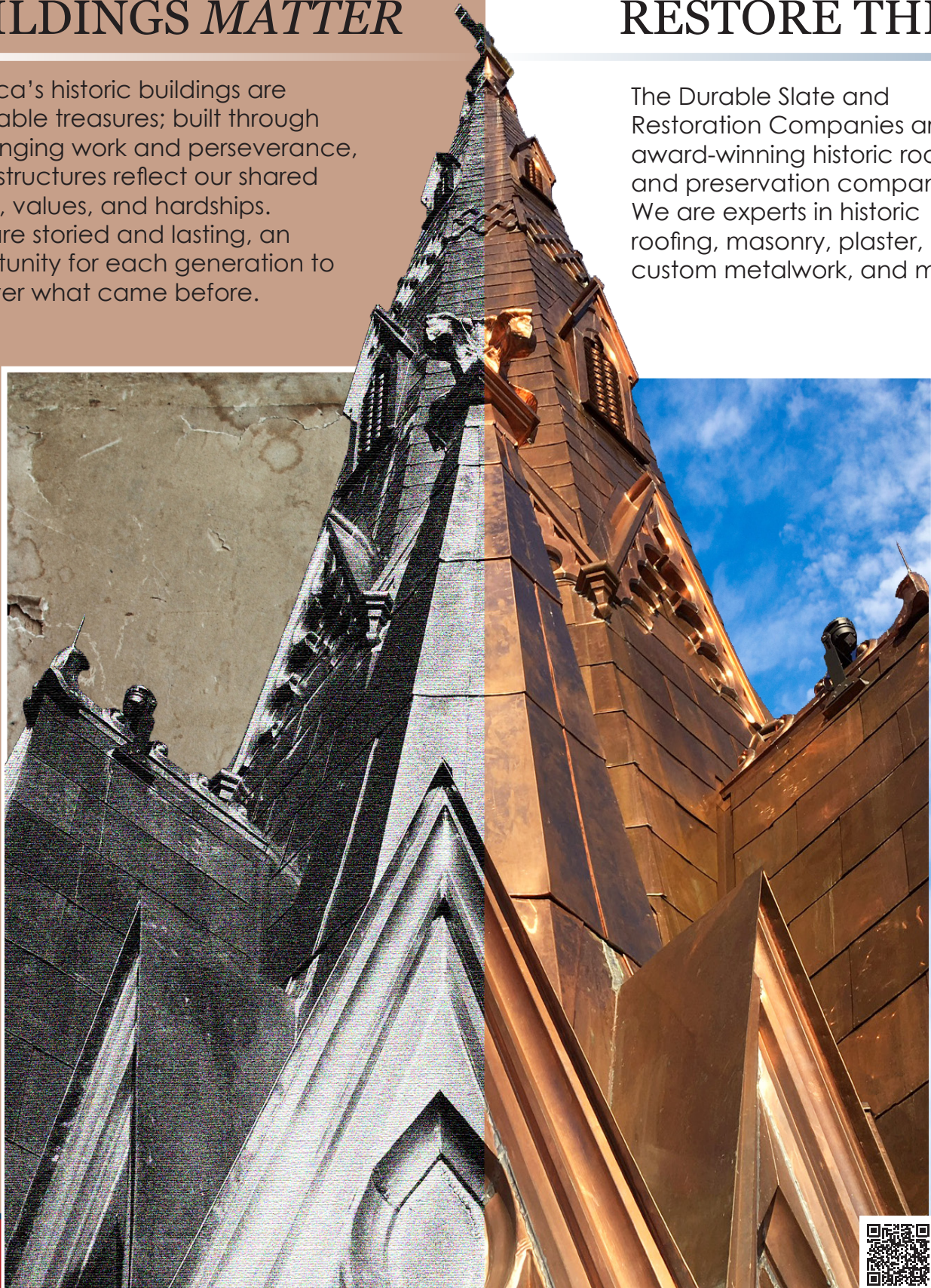

Steeple Square, Dubuque, Iowa



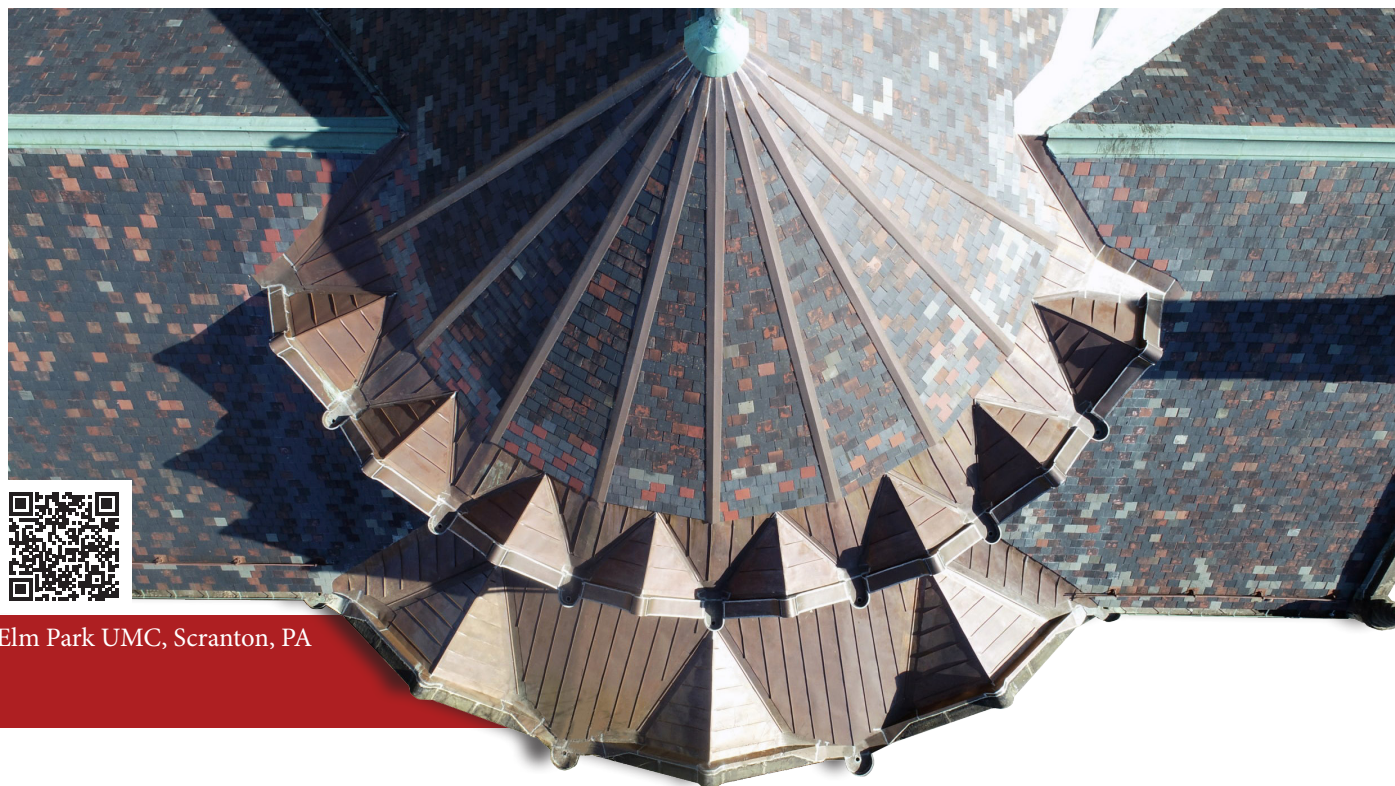

Elm Park UMC, Scranton, PA

Historic buildings were made during a different age when natural materials were the only choice and only legions of hardworking men and women had the time, strength, and talent to see the materials used properly. And while natural materials like slate remain the best choice for the right building, the trade and expertise to use them correctly is unfortunately uncommon. The Durable Slate and Restoration Companies have mastered these traditions and our work has been frequently recognized for its quality, ingenuity, and authenticity.

It is our mission to restore and protect these buildings responsibly, through a combination of modern technique and time-honored craft:

An emphasis on safety, both for our workers and the environment;

The marriage of heavy machinery, hard work, & human tradition;

And a commitment to our in-house training and certification programs, preparing today's Craftsmen for tomorrow's historic preservation work.





Our approach to historic restoration is as forward thinking as it is committed to the past. We take the best lessons of history and combine them with modern standards for a more perfect product.

We follow professional standards established by the National Slate Association, Slate Roofing Contractors of North America, Copper Development Association, and crucially, the guidelines set by the National Park Service.

Our company philosophy - The Durable Way - has lead us to three Gold Circle Awards from the National Roofing Contractors Association, and two honorable mentions, each recognizing outstanding workmanship in some way. We are also the only American company to be honored by the International Federation for the Roofing Trade for our work on Steeple Square in Dubuque, Iowa.

Thank you for taking the time to learn about us and the key people who make everything work.

With decades of experience, our industry-leading training programs, an obsessive focus on quality, and a commitment to historic accuracy, we provide exemplary quality of care, no matter the project size or location.

1

The 2008 National Roofing Contractor's Association (NRCA) Gold Circle Honorable Mention was for All Saints Church, Keokuk, IA, and recognizes outstanding workmanship, especially for particularly challenging projects.

2

The 2005 National Roofing Contractor's Association (NRCA) Gold Circle Honorable Mention was for First Christian Church, Springfield, OH. This project included a new, patterned slate roof, copper flashings, gutters, and ornamental details.

3

Our NRCA 2020 Gold Circle Award honored Steeple Square, Dubuque, IA, in recognition of our Outstanding Workmanship and Innovative Solutions and is awarded to projects that exceed standard roofing practices.

4

First United Methodist Church, Lancaster, OH, was recognized for Outstanding Workmanship, earning us our first NRCA Gold Circle Award in 2006. We fabricated and replaced their complex copper cupola, while expertly protecting our workers.

5

The 2007 Gold Circle Award for Outstanding Workmanship honored the First Congregational Church, Akron, OH, in which we fully restored their roof's timeless appearance.

6

For our work on Steeple Square, Dubuque, Iowa, The Durable Slate and Restoration Companies were given this award for excellence in metal roofing and restoration by the International Federation for the Roofing Trade (IFRD). We are the first American company in 67 years to receive this award; an impressive distinction, considering the many world-class, international projects considered.

7

For our extraordinary use of copper, Steeple Square, Dubuque, IA, joined fifteen other exemplary buildings throughout the United States and Canada in winning 2019's North American Copper in Architecture (NACIA) award.

The Durable Restoration Company is a fully licensed and insured General Contracting Company. We are also a very specialized construction company.

We have the knowledge and expertise to execute complex and historically appropriate renovations for residential and commercial properties. We lend our expertise through all phases of strategic planning to make every project flow smoothly. This includes historic research, design, bidding, construction and final quality check of the completed work.

Technical expertise, obsessive attention to detail and the ability to meet the most demanding project requirements have all contributed to our sustained growth. Durable Restoration serves religious, commercial and institutional clients, as well as industry professionals.

All of our work is undertaken strictly following the Secretary of Interior Standards and Preservation Briefs published by the National Park Service. Commitment to historic detail, careful preparation, and using only the most suitable materials available ensures that these structures persist with their character intact.

Only future generations will know the difference.

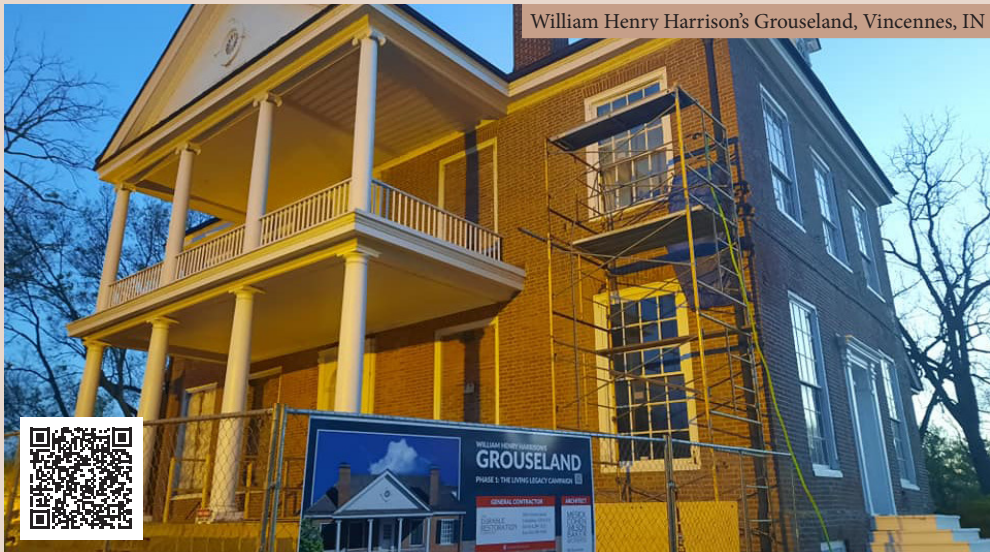



Wedding Cake House, New Orleans, LA

The Durable Slate Company is an award winning historic roofing company. Using stone, metal, and earth, we build the world's best, most lasting roofs.

Established in Columbus, Ohio, over thirty years ago, The Durable Slate Company began small. Through quality service, sound methods, and professional integrity, we quickly grew and now offer our roofing services nationwide. We follow The Durable Way: Incredible craft, service, transparency, and professional integrity.

From slate or clay-tile roofing to copper gutters to precision ornamental metal work, The Durable Slate Company can handle any specialty roofing project of any size, anywhere. Whether small or large, all roof repairs receive the same attention and commitment to quality. You'll love our work.

Over the years, we've been privileged to work on some of America's finest buildings and have earned numerous national and international awards and professional distinctions, including multiple NRCA Gold Circle Awards and the North American Copper in Architecture Award. We are also the only American company to receive the coveted International Federation for the Roofing Trade Award.



Frank Lloyd Wright's Westcott House, Springfield, OH



City Ridge, Washington, DC

Executive Partners

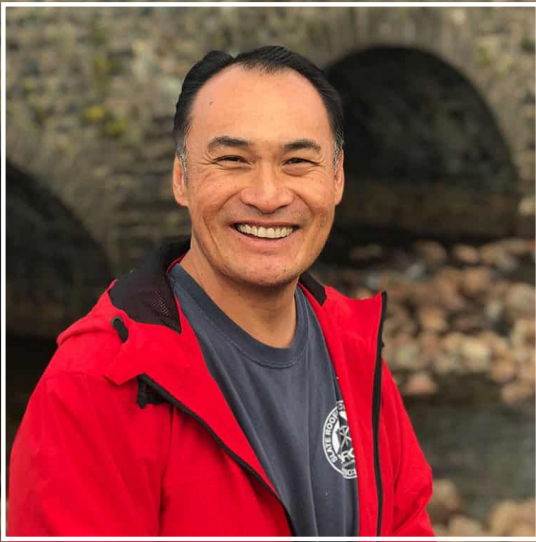

John Chan, Owner

Having worked as a laborer during summer breaks away from college, John came to work fulltime after graduating from UCLA in 1989 with a degree in economics. As a principal in the company, John's expertise is historic roofing. He is one of the leading experts in the field, and has lectured extensively on the subject. John serves on the board of the National Slate Association.



Gary Howes, COO

Gary started his career in the company in 1989 working in the field. He became quite an artisan and was awarded the Builder's Exchange Craftsmanship Award in 1995. Gary is certified by US Heritage Group in Historic Lime Mortar application. Having held numerous technical positions in the company, Gary was able to master the Durable Way, and rose to the level of principal and Executive Vice President of Operations in the company.



Shane Day, AVP of Production

Shane started in the construction business in 1994. He joined The Durable Slate Company in 2001 as a foreman and worked his way up to Assistant Vice President of Quality Control. He was then promoted to the Director of Special Projects position and currently holds the position of Assistant Vice President of Production where he oversees all production for The Durable Group.

Key Employees

Julie Butler, Lead Preservationist

Julie received her MA in Historic Preservation from the University of Florida and is an expert in mortar repointing, plaster casting, masonry and wood detail preservation and material analysis. Before joining The Durable Restoration Company, she worked on a broad range of architectural projects with national and international significance, including several World Heritage Sites.



Jason Lee, AVP of Restoration

Jason has been with The Durable Restoration Company for 14 years and worked in the construction industry for over 20 years. In this time, Jason has earned a well deserved reputation as one of the leading Masons in the Mid-West. He has worked on numerous notable projects such as Steeple Square in Dubuque, IA, St. Andrew's Church in Roanoke, VA, and The Saint James Episcopal Church in Baton Rouge LA.



Richard Jarvis, Estimator

Richard is a University of York graduate, with a MA in Conservation Studies. He brings decades of experience, has worked on projects throughout the US and UK, and is intensely passionate about historic preservation. Since 2004, he has worked as a Historic Preservation Consultant, delivered innumerable lectures on historic rehabilitation, and has helped projects navigate the bureaucratic complexity of National Register nominations and Tax Credits.



Our Historic Preservation work, the materials we use, as well as our methods and craftsmanship, strictly follow the Secretary of Interior Standards and Preservation Briefs published by the National Park Service. This commitment to authenticity and a job done right ensures that these structures are treated properly and set to last for generations to come.



Church of All Saints, Keokuk, Iowa

Built in 1881, the Church of All Saints is an excellent example of Gothic Revival style and is listed on the National Register of Historic Places. Composed of locally sourced clay brick, magnesium limestone, the 60x140 foot structure rests on a foundation of rough limestone. Its centermost tower rises a staggering 180 feet, complete with an eight-sided spire and cross for a total height in excess of 200 feet. It is flanked by two towers, each 75 feet high. All told, Church of All Saints is among the tallest structures in Keokuk. This awesome height made it useful as a signal tower during The Civil War.

The Durable Slate Company replaced All Saint's steeply pitched slate roof; restored the magnificent steeples, including some exquisite ornamental metal work; as well as installed new copper gutters and downspouts. This project was recognized by the National Roofing Contractors Association, earning us a Gold Circle Honorable Mention in 2008.

1

NRCA Gold Circle, Honorable Mention 2008





Steeple Square, Dubuque, Iowa

Originally known as St. Mary's Catholic Church, Steeple Square was built in 1867 and transformed into a community center in 2015. The Durable Restoration Company, brought their steeple back to life and made modifications throughout the project to match the historic nature of the building.

Steeple Square remains one of our largest, most involved projects. Over its course, we installed more than 15,000 pounds (about twice the weight of an elephant) of copper as well as various copper decorative pieces to the steeple. The final product is truly stunning and worth seeing in person.

Our extensive restoration work was recognized by The International Federation for the Roofing Trade (IFD) in 2019. The IFD honored The Durable Restoration Company for our expert metal roofing, making us the first American company in the IFD's history to do so. In addition to this, Steeple Square won the NRCA's 2020 Gold Circle award in recognition of outstanding workmanship and innovative solutions, awarded only to projects that exceed standard roofing practices. More, Steeple Square joined fifteen other exemplary buildings throughout the United States and Canada when it earned 2019's North American Copper in Architecture award, honoring our exemplary use of copper.

IFD Award & Trophy, 2019

6



NRCA Gold Circle, 2020

3



IFD Award & Trophy, 2019

7





88 State Circle, Annapolis, MD

88 State Circle was built during a time of economic turmoil and is an unusually well constructed, late 19th century building with numerous fine and expensive details.

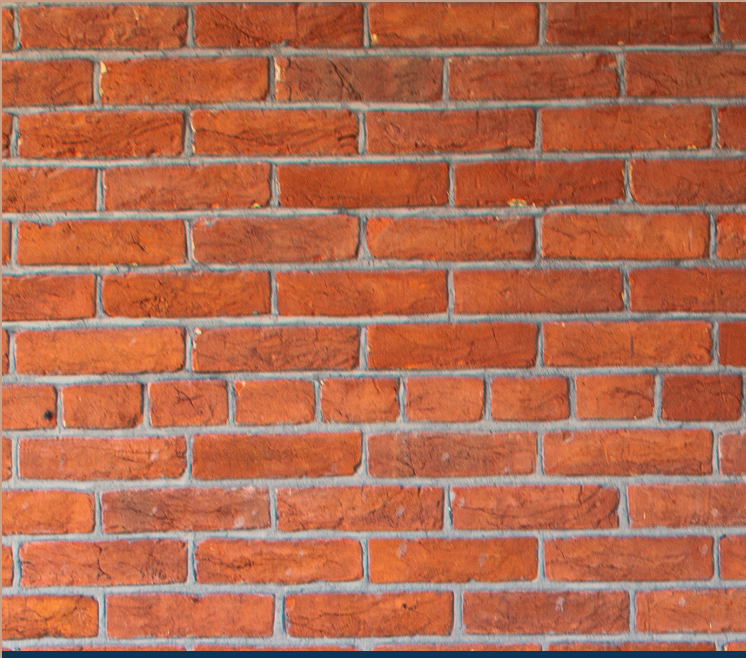

To restore 88 State Circle's historic brick façade, we used Arbortech's plunge tool to remove the improper Portland Cement. Grinders can cut too easily and might injure the historic brick. The Portland Cement was replaced with a more durable and historically appropriate lime mortar. Eroded bricks were carefully patched to match the original brick's color and texture.

A small but important detail, we cut the mortar's joint profile - the sealed space connecting each brick - to match the original historic bricks. This was an important feature of the original façade and well worth preserving. A mortar joint allows water to shed away and can be an attractive part of the wall's design, drawing the eye to the brick or mortar as desired.



All Saints Episcopal, Frederick, MD

All Saints' bell tower experienced a full exterior restoration which included removing and replacing all of the slate on the main steeple and a smaller turret, along with a complete reconstruction of two hand carved finials. The masonry portion of the steeple was spot pointed where necessary and the brownstone elements were restored with Jahn Brownstone repair mortar. All of the brownstone was coated with a vapor permeable mineral coating which will halt any further deterioration from poor past repairs.



Adhering to strict and comprehensive federal guidelines for historic restoration, our craftsmen also completed the stone patching and repair of All Saints' exterior, as seen below.





St. Andrews, Roanoke, VA

The St. Andrew's Catholic Church Steeple/ Masonry Restoration Project took place in Roanoke, Virginia. Construction began on March 23rd, 2014, and ended on December 5th, 2014. The principal features were two steeples clad in ornamental copper and slate.

The goal of this project was the repair, restoration, and preservation of the historic twin spires of the 112 year old St. Andrew's Catholic Church. The structure includes an east and a west spire. Each spire consists of a square masonry tower containing a belfry, and a wood framed slate and copper covered steeple towering above the belfry. Combined, St. Andrews stands a mighty 175 feet.

A detailed assessment of the interior and exterior of both spires was performed and confirmed that both spires had significant structural deterioration. In addition, they were out of plumb by approximately 10-12 inches at the top of the steeple. A subsequent evaluation determined that the top of the east steeple had drifted an additional 3/8 inch over a 6 month period. Insect damage was also found, although the full extent could not be determined. Based upon these results the decision was made to replace the two wood framed steeples with new steel framed steeples and to restore both masonry towers. Steel was used to avoid the risk of future damage from termites and other insects.

Except for the steel frame, the project was the faithful copy, reproduction, and restoration of the original 1902 architectural design for the two steeples.

“Thank you for your hard work to preserve St. Andrew's for future generations to gather and worship. It was a pleasure to have Durable Restoration Company on board with us for both the constructions phases, beginning with the steeples in 2014 and then the latest phase just completed on the exterior. The new slate roof, new copper elements, updated lightning protection, and repointing of the brick, which included repair to the stone elements, were all expertly done on time and within budget. We sincerely appreciate your dedication to make this project a safe and timely one, and we will always think of you as the team that made this happen for our church community.

Father Kevin L. Segerblom, Pastor & Wayne C. Gould, Project Manager



Cincinnati Union Terminal, Cincinnati, Ohio

Built in 1933, Union Terminal was used as a large passenger station that supported seven railroads. As the building aged, its steel structural support began to rust, creating pressure within the building and forcing stones out of the exterior façade.

Our restoration work began with removing the brick backing and the stones to reveal the rusted steel in order for it to be repaired. Once repaired, our work consisted of restoring the damaged brick and matching it to that of the original.

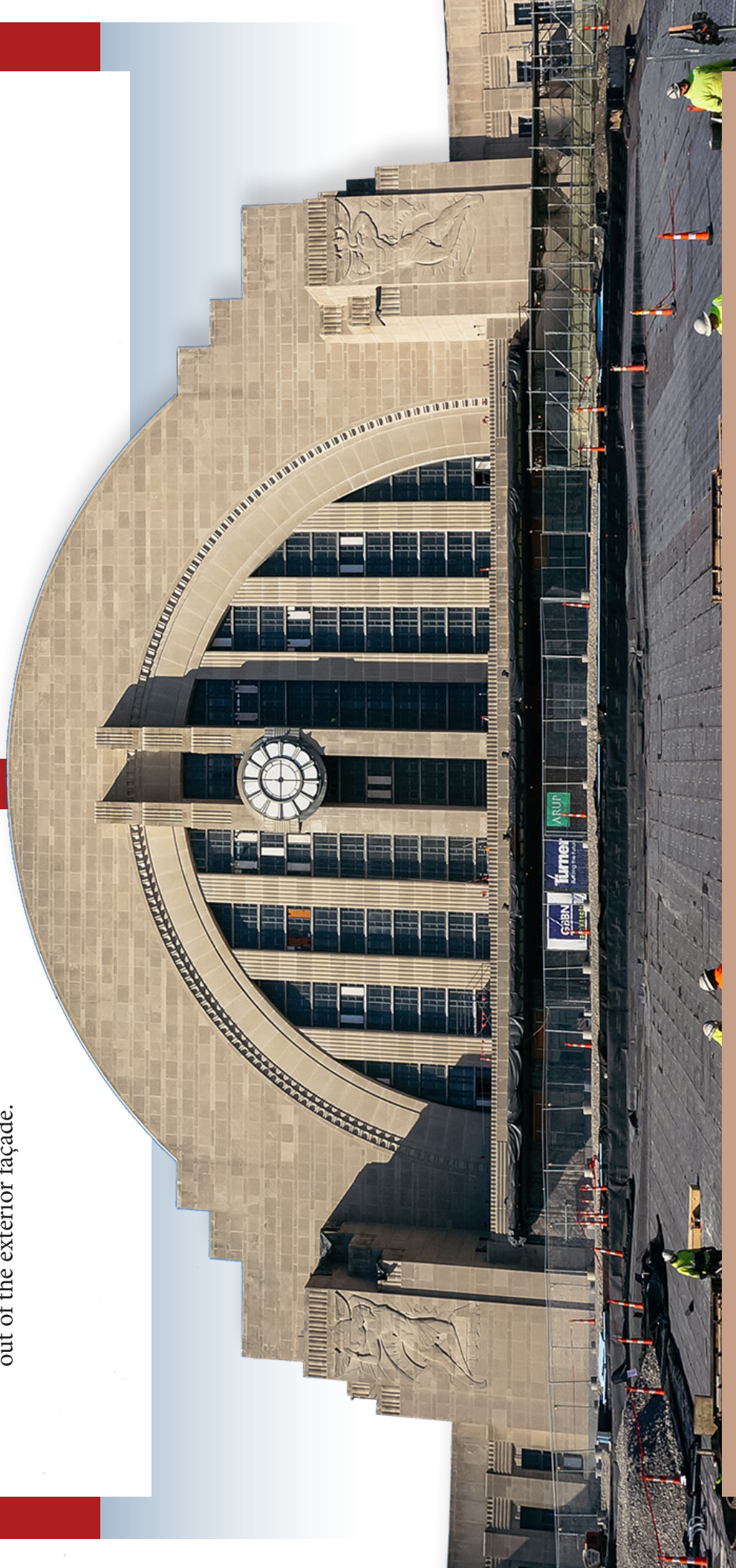



Norwegian Embassy, Washington, District of Columbia

In 1905, Norway established their first embassy in Washington, D.C. and it ranks among Norway's largest. The United States and Norway's close relationship strengthened between 1825 and 1940 when over one-third of Norway's population emigrated to the United States.

Whiting-Turner Contracting Company and The Durable Slate Company collaborated on this project. While Whiting-Turner was responsible for the addition to the embassy, The Durable Slate Company installed insulation and approximately 3,000 square feet of standing seam, pre-patinaed copper. Patina is the green layer that forms on copper due to age and exposure. This type of copper was chosen to pay homage to the Statue of Liberty. Eight inches of poly iso-insulation and plywood was also installed including the curved surfaces.

Lady Liberty's famous green copper came from a mine in the village of Visnes, Norway. The copper in this town was discovered in 1865, ten years before the Statue of Liberty was built and is be among the most active Norwegian copper mines in history. In Visnes, a replica of the Statue of Liberty can be found holding her torch to pay tribute to the original historic monument.

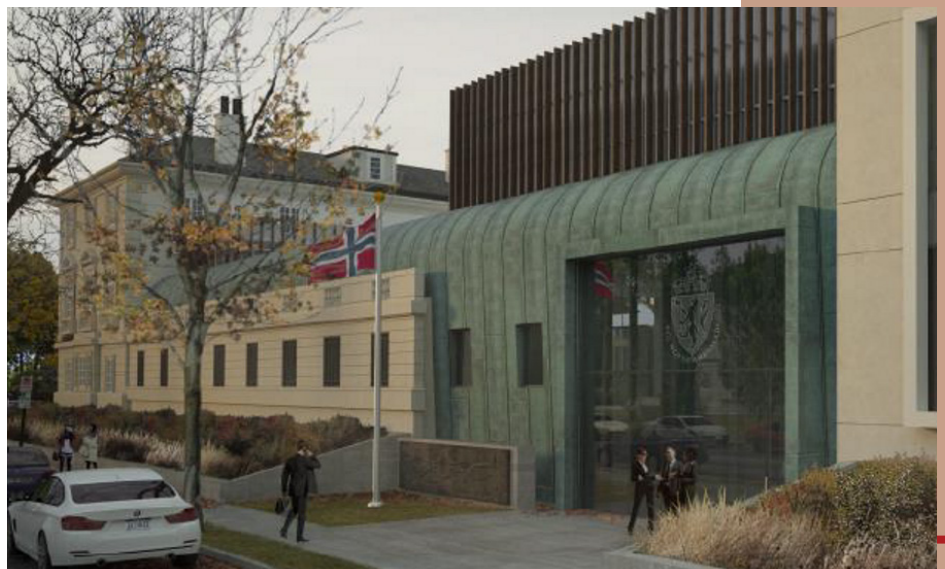



Steeple, Domes, and Roofs



When it comes to steeples, domes and historic roofing restoration and repairs, few have more experience and expertise than our team. Our in-house experts have studied and examined these types of structures, materials and installation techniques throughout the world. We will bring all of this knowledge and passion to you to help ensure your project has the correct assessment to ensure the original look and aesthetics are preserved for many generations to come.



Florida State Capital Building, Tallahassee, FL

Assessment & Consulting



Our team of knowledgeable historic preservationists offers the ability to create many documents that can aid in the continued preservation of your structure. These include preservation plans, Condition Assessments, Restoration Priority lists and even material and method specifications. We can even create essentially an owner's manual for the proper site specific techniques of preservation.



Pezet Towers, Lima, Peru

Historic Brick, Stone, & Terra Cotta



When it comes to historic brick and stone masonry, the mortar utilized is equally important to the integrity of the structure. Our team will test and analyze the mortar used as well as the cause of the deterioration in the stone, terra cotta, or brick, and educate the customer of these causes and determine solutions. Historic materials, specifically mortar and brick from pre 1930 are vastly different than modern materials and necessitate specific knowledge to repair correctly and not cause greater deterioration.



Annaburg Manor, Manassas, VA



Tomochichi Federal Building, Savannah, GA



Structural Stabilization

Preservation of a structure's stability is the first step in saving the integrity of a historic structure, a solid base is needed to support the architectural elements that contribute to the buildings significance. There are many different techniques our team use in our structural stabilization projects, each tailored to the project at hand. Typically our team of experts includes Engineers who specialize in historic buildings along with historic craftsmen.



Newnan Street Bridge, Jacksonville, FL



Historic Coatings

Many historic structures feature historic coatings. These range from lead paint, oil paint, mineral coatings, thermoseal and/or modern paints. While some coatings can be historically appropriate for the building, sometimes they are the main reason for deterioration and need to be remediated.



Abraham Lincoln Birthplace, Hodgenville, KY



Historic Plaster

While the techniques for historic plaster application are remembered by few, our team of artisans ensures the techniques live on well into the future, by having mastered and utilizing the three-coat lime plaster that was used almost exclusively until the end of the 19th century. This technique is unmatched in its historical appropriateness, strength and durability, and is incredibly fire and acoustic resistant.

Built in 1905, First United Methodist is a stunning part of downtown Lancaster. Complex stained glass, a lush clay tile roof, crowned by a stunning copper cupola, the eye can't help but to be drawn skyward.

A century later, this cupola - designed to last for 80 years - was showing clear signs of leakage and general deterioration.

The Durable Slate Company was contracted to completely replicate the cupola, along with its supporting wood structure in time for the

church's centennial celebration. Ultimately, we also installed a custom gutter system, repaired portions of 10" Conosera clay tile roof, and restored the stained glass below the cupola.

Our hard work was recognized by the National Roofing Contractors Association who awarded us our first Gold Circle award in 2006 as Project of the Year and the Gold Circle Safety Award for our commitment to both employee and pedestrian safety, going so far as to close two main streets in downtown Lancaster while the cross and sky-light were removed.



4 NRCA Gold Circle Award, 2006
& Gold Circle Safety Award, 2006

FirstUnited Methodist, Lancaster, OH



St. James Episcopal, Baton Rouge, LA

The Durable Slate Company first worked on St. James Episcopal Church in 2009 and installed a new Vermont grey slate roof on the church, school, administration building, and the gymnasium. In addition to this, we installed the ornamental copper on the church, including the ornamental copper on top of the steeple. Eventually, The Durable Restoration Company, returned to work on the historic masonry. A previous contractor had coated the original lime-based mortar with Portland cement, suffocating the underlying brick and causing damaging water retention. Our crews removed the Portland cement, raked the original mortar back, and applied new lime-based mortar designed to seamlessly match the original 19th century installation.

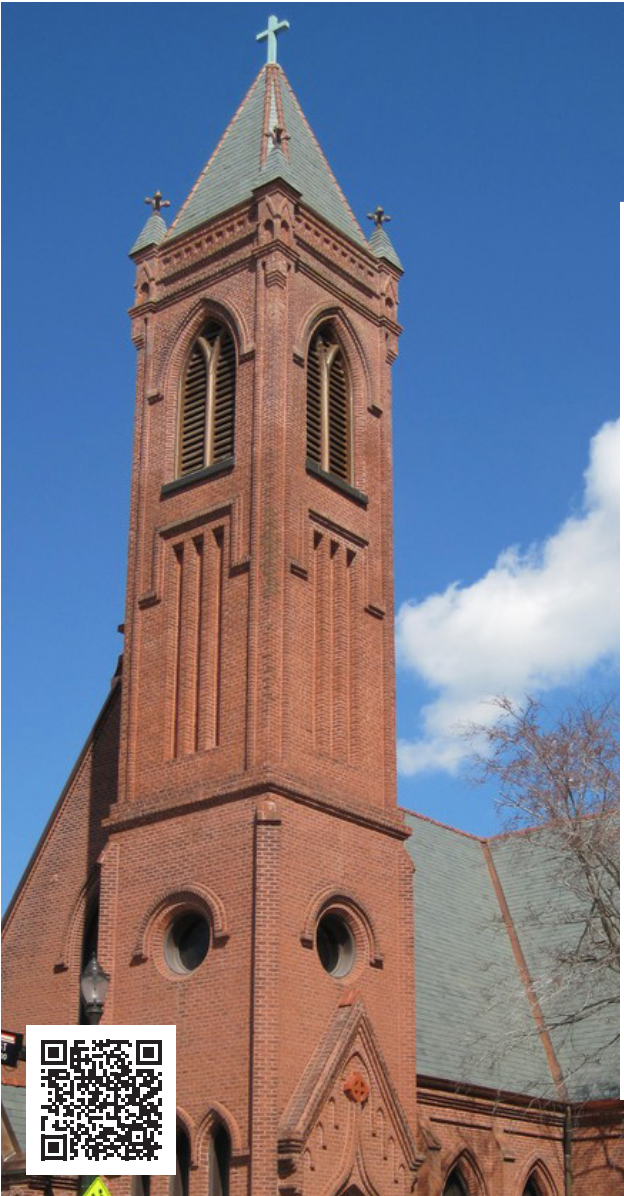

Accomack County Courthouse, Accomack, VA

The Accomack County Courthouse underwent a full restoration where The Durable Restoration Company specifically focused their efforts on the masonry restoration. The entire building was selectively re-pointed where past improper repairs or failing mortar was observed. Due to this building's unique original mortar color, a deep red, and fine butter joint profile, the mortar was analyzed, color and composition matched and installed in a way to allow our repairs to blend into the original, still present and functioning, mortar joints. The brick needed for brick rebuilding was custom made to match exactly that specific brick, which was quite unique to the location, and made on site for this building as it was constructed. Brownstone lintels and sills were also repaired using custom stone patch and small brick damage was repaired using custom brick patch.

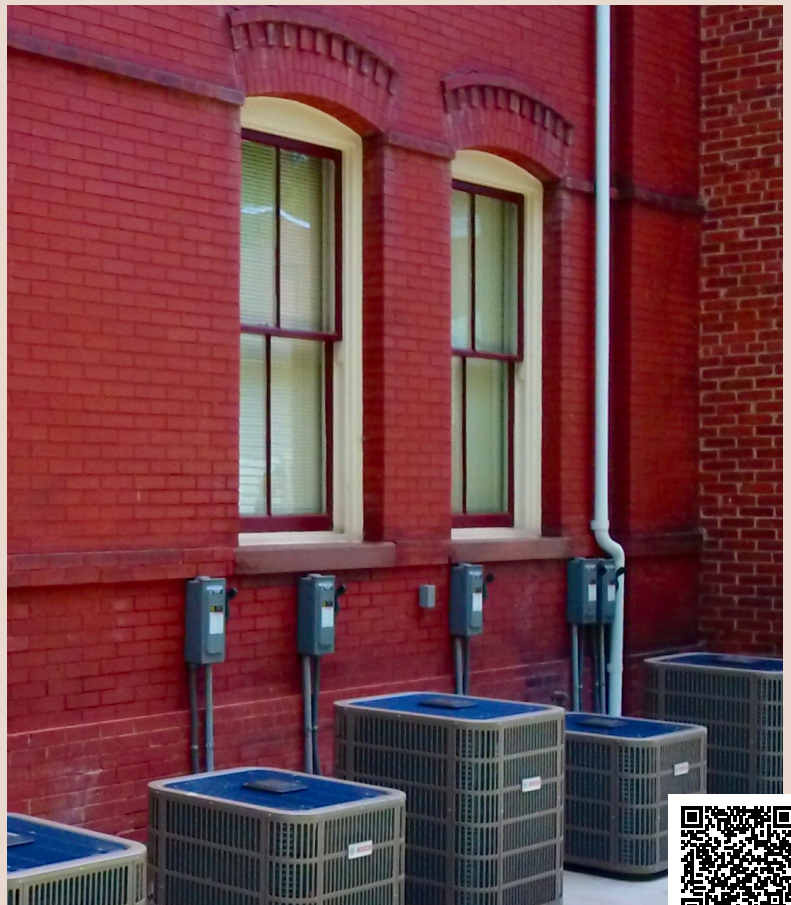

Jason Lee

AVP of Production

The Durable Group
The Durable Slate Company
The Durable Restoration
Company

8725 Bollman Place, Suite 8
Savage, Maryland 20763

410.235.7500

Expertise in Historic Repair &
Restoration

Masonry & Stone
Copper & Metalwork
Carpentry & Woodworking
Plaster

Education

Bachelor of Arts, Columbus
College of Art & Design

Certifications

Certified JAHN Restoration
Mortars

Awards

- 2019 IFD International
Roofing Award
- 2019 North American
Copper in Architecture
award
- 2020 NRCA Gold Circle
Award

Summary

Jason has been with The Durable Restoration Company for 14 years. Jason has been in the Construction Industry for over 25 years establishing a reputation as one of the leading restoration craftsman on the east coast.

Jason has been responsible for numerous notable projects such as Steeple Square in Iowa, The Old Capitol Building dome in Tallahassee FL, Tampa City Hall Dome in Tampa, FL, St. Charles Ave Presbyterian Church in New Orleans LA and The Saint James Episcopal Church in Baton Rouge LA.

Jason has a vast knowledge and understanding of historic restoration and structures. He brings decades of hands-on experience to the aspiring craftsman at The Durable Restoration Company by splitting his time between the company's offices in Ohio and Maryland. Jason's expertise extends throughout the restoration process, including historic roofing methods, historic masonry material and lime mortars.

Notable Projects

St. Andrews Roman Catholic Church

- Roof & Steeple restoration
- Masonry façade repair & restoration

Steeple Square, Dubuque, Iowa

- Copper steeple roof & ornamental copper accoutrements
- Copper fabrication & installation
- 2019 International IFD Grand Award winner

Tampa City Hall, Tampa, Florida

- Complete copper dome replacement
- Copper fabrication & installation

Florida State Capitol Dome, Tallahassee, Florida

- Complete copper dome replacement
- Copper fabrication & installation Cincinnati Museum Center at Union Terminal, Cincinnati, Ohio
- Stone façade repair & restoration

Julie Helene Butler

Director of Preservation
Sr. Project Manager

Summary

The Durable Group
The Durable Slate Company
The Durable Restoration Company

8725 Bollman Place, Suite 8
Savage, Maryland 20763
410.235.7500

Expertise in Historic Preservation
Historic Masonry, Stone, Marble,
Plaster & Bronze Restoration
Slate, Clay Tile, Copper Roofing

Education

- SAVANNAH COLLEGE OF ART AND DESIGN, Savannah, GA August 2012
- Master of Arts in Historic Preservation
- UNIVERSITY OF FLORIDA, Nantucket, MA Summer 2010
- Preservation Institute: Nantucket, Graduate Summer Program
- UNIVERSITY OF MARY WASHINGTON, Fredericksburg, VA May 2010
- Bachelor of Arts in History, Bachelor of Arts in Historic Preservation
- UNIVERSITY OF VIRGINIA, Falmouth, Jamaica, W.I. Summer 2009 UVA Field School in Architectural History

Training & Certifications

- OSHA 30 hour Card
- Competent person Trained for Scaffold Erection
- Lead Awareness certification

Julie has been with the Durable Restoration Company for 6 years where she has undertaken many varied masonry restoration projects, particularly focusing on mortar conditions and appropriate repairs.

Julie joined Team Durable after having worked on a broad range of architectural projects with national and international significance. She spent considerable time performing quality control for the modernization of the Eisenhower Executive Office Building in Washington D.C. In addition to performing masonry documentation and conservation duties at World Heritage Sites specifically at the St Trophime Cathedral in Arles, France and concrete block analysis for the Annie Pfeiffer Chapel at Florida Southern College in Lakeland, Florida.

Her expertise spans many disciplines, such as mortar analysis, plaster casting, detail preservation and material analyses and relationships; especially for structures experiencing extreme weather conditions.

Notable Projects

- Accomack County Courthouse
- Annaburg Manor
- Compton Bassett Manor
- Tomochichi Federal Courthouse
- 88 State Circle
- St Andrews Catholic Church
- All Saints Church

Don Holton

Masonry Superintendent

The Durable Group
The Durable Slate Company
The Durable Restoration
Company

8725 Bollman Place, Suite 8
Savage, Maryland 20763

410.235.7500

Expertise in Historic Repair &
Restoration

Masonry & Stone
Carpentry & Woodworking
Plaster

Training & Certifications

- OSHA 30 hour Card
- Competent person Trained for Scaffold Erection
- Lead Awareness certification

Summary

Don has been with The Durable Restoration Company for 7 years.

Don has been in the Construction Industry for over 33 years establishing a reputation as one of the leading restoration masons and a certified historic plasterer Don has been the superintendent for numerous notable projects such as The Tomochichi Courthouse restoration in Savannah, GA; the Compton Bassett House Stabilization in Upper Marlboro, MD; The Cincinnati Museum Center at Union Terminal, Cincinnati, OH and Don has immense experience as a mason for both brick masonry and stone masonry and is an extremely skilled plasterer.

Don is able to consistently produce high quality, historically appropriate work while consistently following Secretary of the interior standards for Historic Preservation and National Park service briefs.

Notable Projects

Tomochichi Federal Courthouse, Savannah, GA

- Steel Restoration and Stabilization
- Masonry façade repair & restoration

Compton Bassett Manor, Upper Marlboro, MD

- Complete Stabilization of masonry structure

Cincinnati Museum Center at Union Terminal, Cincinnati, OH

- Stone façade repair & restoration

Our Masons

Jeff Billings

35 years masonry/ construction experience

Project Experience

Takoma Park Presbyterian, Tacoma Park, MD

- Masonry & stone restoration (2020-2021)

Alexander Randell Double House, Annapolis, MD

- Masonry Restoration (2020)

Edgar Allen Poe House, Baltimore MD

- Masonry Restoration (2019-2021)

DC Water Historic Pump Station, Washington DC

- Masonry and stone restoration (2018-2019)

Federal Reserve Building, Baltimore MD

- Masonry Restoration(2017-2018)

Fort Meade Building Historic Barracks

- Masonry Restoration(2017)

East Donagal Insurance Building, PA

- Masonry Restoration (2015-2017)

Certifications

- Osha 30 Certified
- Certified Scaffold installer
- Arial Lift Certified
- Certified Jahn Installer
- Silica Hazard Certified
- Lead Awareness Certification

Otis (Dwayne) Carroll

22 years masonry and 22 years construction experience

Certifications:

- Certified Scaffold installer
- Ariel Lift Certified
- Certified Jahn Installer
- Silica Hazard Certified
- Lead Awareness Certification

Project experience:

Annaburg Manor, Manassas, VA

- Masonry & Stone restoration (2020-2021)

The Evangelical Lutheran Church, Frederick, MD

- Masonry & Stone restoration (2020-2021)

Pritchard House, Titusville, FL

- Masonry Restoration (2020)

Alexander Randell Double House, Annapolis, MD

- Masonry Restoration (2020)

Accomack County Courthouse, Accomack, VA

- Masonry Restoration (2019-2020)

Dc Water Historic Pump Station, Washington DC

- Masonry and stone restoration (2018-2019)

Lorton Prison

- Masonry Restoration, stone patch, repoint- (2017)

Chatham Manor, Fredericksburg, VA

- Masonry Restoration- (2016)

Union Terminal Museum, Cincinnati, OH

- Stone Restoration- (2015-2016)

9 years masonry experience and 21 years construction experience

Certifications:

- Certified Scaffold installer
- Ariel Lift Certified
- Certified Jahn Installer
- Silica Hazard Certified
- Lead Awareness Certification

Project experience:

Annaburg Manor, Manassas, VA

- Masonry & Stone restoration (2020-2021)

The Evangelical Lutheran Church, Frederick, MD

- Masonry & Stone restoration (2020-2021)

Pritchard House, Titusville, FL

- Masonry Restoration (2020)

Alexander Randell Double House, Annapolis, MD

- Masonry Restoration (2020)

Accomack County Courthouse, Accomack, VA

- Masonry Restoration (2019-2020)

Dc Water Historic Pump Station, Washington DC

- Masonry and stone restoration (2018-2019)

Lorton Prison

- Masonry Restoration, stone patch, repoint- (2017)

Chatham Manor, Fredericksburg, VA

- Masonry Restoration- (2016)

Union Terminal Museum, Cincinnati, OH

- Stone Restoration- (2015-2016)

Miguel Flores

15 years masonry and 20 years construction experience

Certifications:

- Osha 30 Certified
- Certified Scaffold installer
- Ariel Lift Certified
- Certified Jahn Installer
- Silica Hazard Certified
- Lead Awareness Certification

Project experience:

Annaburg Manor, Manassas, VA

- Masonry & Stone restoration (2020-2021)

Edgar Allen Poe House, Baltimore MD

- Masonry Restoration (2019-2021)

The Evangelical Lutheran Church, Frederick, MD

- Masonry & Stone restoration (2020-2021)

Alexander Randell Double House, Annapolis, MD

- Masonry Restoration (2020)

DC Water Historic Pump Station, Washington DC

- Masonry and stone restoration (2018-2019)

Compton Bassett House, Upper Marlboro, MD

- Stabilization and Masonry restoration (2018-2019)

St James Church, Baton Rouge, LA

- Masonry Restoration (2017-2018)

All Saints Episcopal Church, Frederick, MD

- Stone Restoration (2016-2017)

Union Terminal Museum, Cincinnati, OH

- Stone Restoration- (2015-2016)

The Durable Slate Company

■ Mid-Atlantic Office
8725 Bollman Place, Suite 8
Savage, MD 20763
(410) 235-7500

■ Cincinnati Region
170 Novner Drive
Cincinnati, OH 45215

(513) 621-3455

■ Mid-West Headquarters
3933 Groves Road,
Columbus, OH 43232
(614) 299-7100

■ Cleveland Region
3705 Lee Road, Suite 2-C
Shaker Heights, OH
44120

(216) 751-0151

☎ 1 (877) 340-9181

🌐 www.durableslate.com

The Durable Slate Company is a nationally available, award winning historic roofing company. We build and restore the world's best, most lasting slate, copper, and tile roofs.

The Durable Restoration Company

■ DRC Mid-Atlantic
8725 Bollman Place, Suite 8
Savage, MD 20763
(410) 235-7500

■ DRC Mid-West
3933 Groves Road,
Columbus, OH 43232
(614) 299-7100

☎ 1 (877) 340-9182

🌐 www.durablerestoration.com

The Durable Restoration Company is a nationally available, fully licensed and insured General Contracting Company. We specialize in historic building restoration and preservation.

